

Instrument No. 034227
 State of Iowa, Boone County, SS
 Filed for Record at 2:31 A.M.
 This 11 day of June 2003
 Sheryl J. Thul, Recorder, Fees \$ 70 fee
 Number of Pages 6

ret. to -
BOONE COUNTY BOARD OF SUPERVISORS
BOONE COUNTY, IOWA

ORDINANCE NO. 49

ORDINANCE AMENDING THE OFFICIAL BOONE COUNTY ZONING MAP

AMENDMENT TO REDESIGNATE PART OF THE SW ¼ OF THE SE ¼ OF SECTION 26-82-26, BOONE COUNTY, IOWA, CONTAINING LOTS 1-10 OF SWEDE POINT SUBDIVISION FROM A-1 (AGRICULTURE) TO R-1 (RESIDENTIAL) AS IDENTIFIED ON THE ATTACHED MAP.

WHEREAS, In this case, Allen and Harold Olson petitioned Boone County to rezone the property described hereinabove from A-1 (Agriculture) to R-1 (Residential) to accommodate a residential subdivision.

WHEREAS, The Director of Planning and Development forwarded a recommendation for approval to the Boone County Zoning Commission. The Zoning Commission held a public hearing on April 28, 2003 in accordance with Iowa Code. The Zoning Commission accepted a motion of "recommendation of approval" to the Boone County Board of Supervisors for the rezoning at the property noted hereinabove.

WHEREAS, According to the Boone County Land Division Ordinance property is to be rezoned to the appropriate use prior to Final Plat Approval of a Major Subdivision. The passage of this amendment will accomplish that requirement for Swede Point Subdivision.

NOW, THEREFORE, BE IT RESOLVED BY THE BOARD OF SUPERVISORS OF BOONE COUNTY, IOWA AS FOLLOWS:

SECTION ONE: That Boone County shall, and it does hereby, approve an amendment to the Official Zoning Map that the property legally described as follows: PART OF THE SW ¼ OF THE SE ¼ OF SECTION 26-82-26, BOONE COUNTY, IOWA, CONTAINING LOTS 1-10 OF SWEDE POINT SUBDIVISION, BE RE-ZONED FROM A-1 (AGRICULTURE) to R-1 (RESIDENTIAL).

SECTION TWO: That this amendment shall be in full force and effect from and after its passage and approval in the manner provided by law.

Moved by Reed, second by O'Brien to approve the first consideration of Ordinance #49 amending the official Boone County Zoning Map on May 16, 2003. NO: None; YES: Sorensen, O'Brien, Reed. Motion carried.

Moved by Reed, Sorensen stepped down to second the motion to approve the second consideration of Ordinance #49 amending the official Boone County Zoning Map on May 19, 2003. NO: None; YES: Sorensen, Reed. O'Brien was absent. Motion carried.

Moved by O'Brien, second by Reed to approve the third consideration and adopt Ordinance #49 amending the official Boone County Zoning Map on May 21, 2003. NO: None; YES: Sorensen, O'Brien, Reed. Motion carried.

**Map available in the Planning & Development Office.

Albert H. Sorensen

Chairman
Boone County Board of Supervisors

5-30-03

Date

Philippe E. Meier
ATTEST:

Philippe E. Meier, County Auditor

5-30-03

Date



Boone County

Exhibit A

Boone County G.I.S. cadastral map data does not replace or modify land surveys, deeds, and for other legal instruments defining land ownership and use.

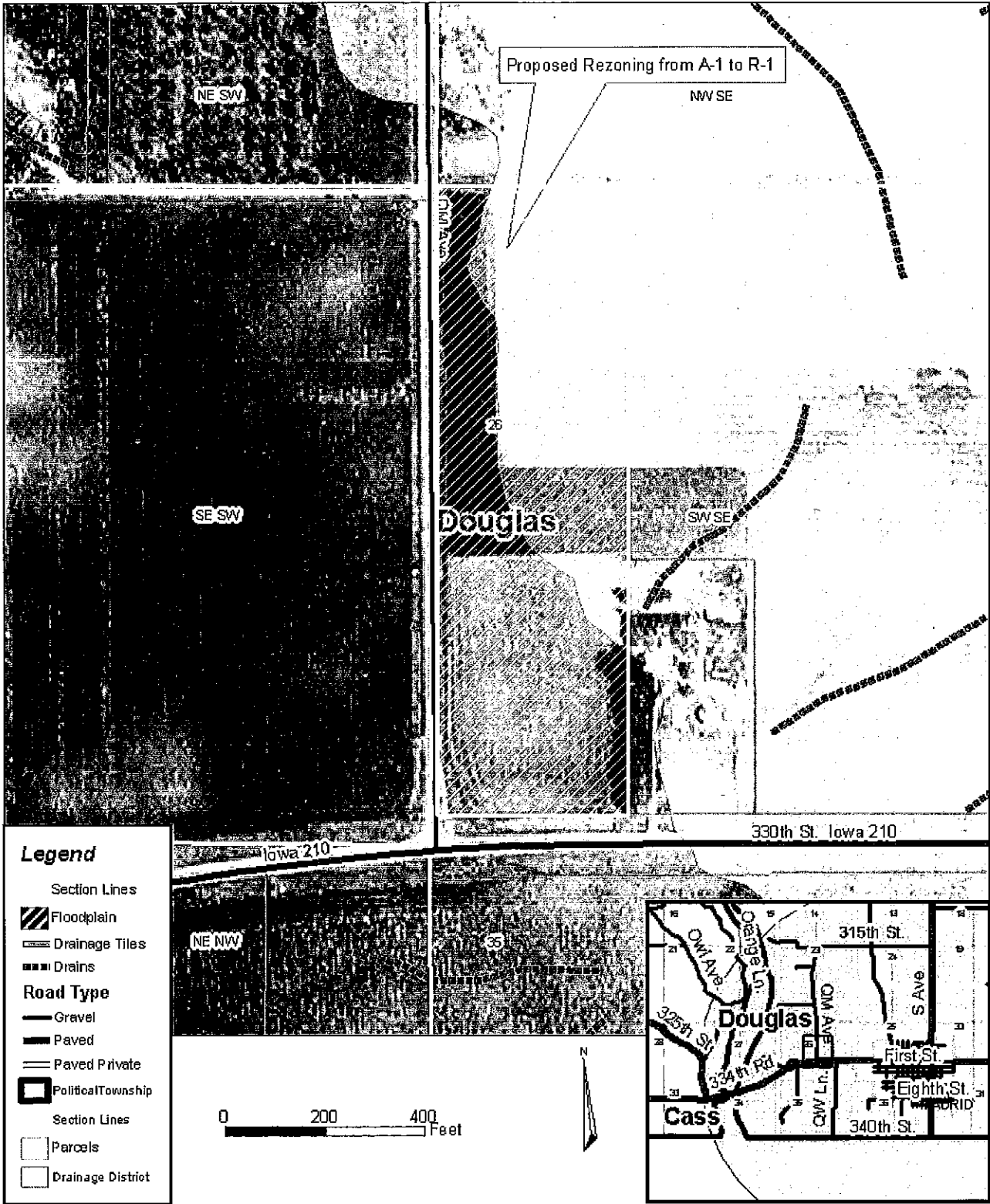

- Legend**
- Section Lines
 - Floodplain
 - Drainage Tiles
 - Drains
 - Road Type**
 - Gravel
 - Paved
 - Paved Private
 - Political/Township
 - Section Lines
 - Parcels
 - Drainage District